



Christian County Commission

100 West Church St, Room 100
Ozark, MO 65721

Meeting: 05/30/19 08:55 AM

Department: County Clerk

Category: Meeting Items

Prepared By: Madi Hires

Initiator: Madi Hires

Sponsors:

SCHEDULED

MEETING ATTACHMENTS (ID # 5066)

DOC ID: 5066

Meeting Attachments

ATTACHMENTS:

- Addendum - Ozark Bank Agreement (PDF)
- Fully Executed Addendum to Ozark Bank Agreement (PDF)
- US Forest Service - Easement Termination - Lookout Rd. (PDF)

The Christian County Commission
100 W Church St, Room 100
Ozark, MO 65721

RE: Addendum to BANKING AGREEMENT dated July 6, 2009

The following addendum shall become a part of the Banking Agreement executed between Ozark Bank and Christian County on July 6, 2009. The purpose of the addendum is to modify the required market value of the pledged security/collateral from 110% of the amount of funds on deposit, less the amount that is insured by the Federal Deposit Insurance Corporation, (FDIC) to 100% of the amount of funds on deposit, less the amount that is insured by the Federal Deposit Insurance Corporation, (FDIC).

Existing language of Section 3.3:

3.3 The County and The Office Holders require that the market value of the pledged security/collateral be 110% of the amount of funds on deposit at all times, less the amount that is insured by the Federal Deposit Insurance Corporation, (FDIC).

Addended language of Section 3.3:

3.3 The County and The Office Holders require that the market value of the pledged security/collateral be 100% of the amount of funds on deposit at all times, less the amount that is insured by the Federal Deposit Insurance Corporation, (FDIC).

This addendum shall be in full force and effect from and after its passage, the ___ day of _____, 2019.

THE CHRISTIAN COUNTY COMMISSION

Ralph Phillips
Presiding Commissioner

Mike Robertson
Eastern Commissioner

Hosea Bilyeu
Western Commissioner

APPROVED BY:

OZARK BANK

By: _____
Dan Mathenia, Senior EVP/CFO

CHRISTIAN COUNTY, MISSOURI

By: _____
Ralph Phillips, Presiding Commissioner

By: _____
Mike Robertson, Eastern Commissioner

By: _____
Hosea Bilyeu, Western Commissioner

ATTEST:

By: _____
Kay Brown, County Clerk

By: _____
Ted Nichols, County Collector

By: _____
Karen Matthews, County Treasurer

APPROVED AS TO FORM

By: _____
John W. Housley, County Counselor

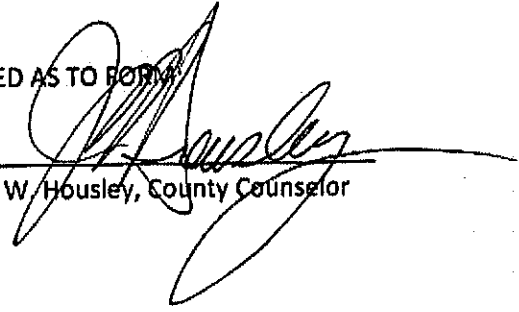
A large, stylized handwritten signature in black ink, which appears to be "John W. Housley", is written over the signature line and extends to the right.

APPROVED BY:

OZARK BANK

By: 
Dan Mathenia, Senior EVP/CFO

CHRISTIAN COUNTY, MISSOURI

By: 
Ralph Phillips, Presiding Commissioner

By: 
Mike Robertson, Eastern Commissioner

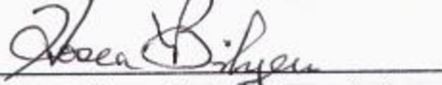
By: 
Hosea Bilyeu, Western Commissioner

ATTEST:

By: 
Kay Brown, County Clerk

By: 
Ted Nichols, County Collector

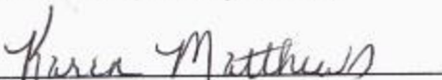
By: 
Karen Matthews, County Treasurer

APPROVED AS TO FORM

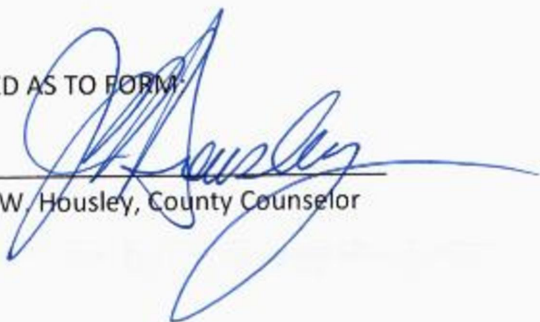
By: 
John W. Housley, County Counselor

The Christian County Commission
100 W Church St, Room 100
Ozark, MO 65721

RE: Addendum to BANKING AGREEMENT dated July 6, 2009

The following addendum shall become a part of the Banking Agreement executed between Ozark Bank and Christian County on July 6, 2009. The purpose of the addendum is to modify the required market value of the pledged security/collateral from 110% of the amount of funds on deposit, less the amount that is insured by the Federal Deposit Insurance Corporation, (FDIC) to 100% of the amount of funds on deposit, less the amount that is insured by the Federal Deposit Insurance Corporation, (FDIC).

Existing language of Section 3.3:

- 3.3 The County and The Office Holders require that the market value of the pledged security/collateral be 110% of the amount of funds on deposit at all times, less the amount that is insured by the Federal Deposit Insurance Corporation, (FDIC).

Addended language of Section 3.3:

- 3.3 The County and The Office Holders require that the market value of the pledged security/collateral be 100% of the amount of funds on deposit at all times, less the amount that is insured by the Federal Deposit Insurance Corporation, (FDIC).

This addendum shall be in full force and effect from and after its passage, the 30 day of May, 2019.

THE CHRISTIAN COUNTY COMMISSION

Ralph Phillips
Presiding Commissioner

Mike Robertson
Eastern Commissioner

Hosea Bilyeu
Western Commissioner



CHRISTIAN COUNTY COMMISSION

100 W Church Street, Room 100

Ozark, Missouri 65721

Phone: 417-582-4300 • Fax: 471-581-5924

Ralph Phillips
Presiding Commissioner

Hosea Bilyeu
Western Commissioner

Mike Robertson
Eastern Commissioner

US Forest Service
Ava Ranger District
Attn: District Ranger Cody Lunsford
1006 S Jefferson Ave
Ava, MO 65608

May 30, 2019

RE: Easement Termination, Lookout Road, Christian County, MO

Ranger Lunsford,

Christian County has been coordinating with your District for several months to begin the process of terminating the easement for Lookout Road. The section of roadway proposed for termination begins at 36.91071 N, 93.13359 W and ends at 36.89474 N, 93.10011 W. This includes approximately three (3) miles of Lookout Road that are wholly surrounded by US Government land. Christian County will continue to maintain Center Road/Lookout Road where these easements lead to residential properties, including the low water crossing at Bull Creek. In addition, the County will also maintain from Cobb Ridge Campground east to State Highway H. A map has been attached illustrating these limits.

The County currently has several maintenance agreements with the US Forest Service and we are operating to the best of our ability to maintain these roadways. However, we have had difficulty maintaining Lookout due to several factors, the most critical being that this roadway is often used as an ATV/dirt bike trail by campers and local residents. The materials that we purchase, place and shape are repeatedly lost in a single weekend. In addition, this three (3) mile segment of roadway is the largest continuous section that we maintain that does not serve any private owners. We believe that continuing to maintain Lookout Road places an unreasonable burden on the County.

It is our understanding that once this request is received, the US Forest Service will complete a Termination of Easement document that will be returned to the County for signature. If there is any additional information that we can provide during that time, please do not hesitate to contact us.

Attachment(s): (A) Map, Limits of Termination
(B) Map, Parcel Ownership

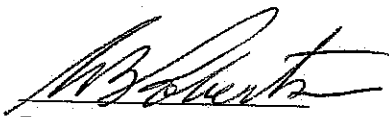
Eastern Commissioner
Mike Robertson

Presiding Commissioner
Ralph Phillips

Western Commissioner
Hosea Bilyeu

US Forest Service
Ava Ranger District
Attn: District Ranger Cody Lunsford
1006 S Jefferson Ave
Ava, MO 65608

May 30, 2019

RE: Easement Termination, Lookout Road, Christian County, MO

Ranger Lunsford,

Christian County has been coordinating with your District for several months to begin the process of terminating the easement for Lookout Road. The section of roadway proposed for termination begins at 36.91071 N, 93.13359 W and ends at 36.89474 N, 93.10011 W. This includes approximately three (3) miles of Lookout Road that are wholly surrounded by US Government land. Christian County will continue to maintain Center Road/Lookout Road where these easements lead to residential properties, including the low water crossing at Bull Creek. In addition, the County will also maintain from Cobb Ridge Campground east to State Highway H. A map has been attached illustrating these limits.

The County currently has several maintenance agreements with the US Forest Service and we are operating to the best of our ability to maintain these roadways. However, we have had difficulty maintaining Lookout due to several factors, the most critical being that this roadway is often used as an ATV/dirt bike trail by campers and local residents. The materials that we purchase, place and shape are repeatedly lost in a single weekend. In addition, this three (3) mile segment of roadway is the largest continuous section that we maintain that does not serve any private owners. We believe that continuing to maintain Lookout Road places an unreasonable burden on the County.

It is our understanding that once this request is received, the US Forest Service will complete a Termination of Easement document that will be returned to the County for signature. If there is any additional information that we can provide during that time, please do not hesitate to contact us.

Attachment(s): (A) Map, Limits of Termination
(B) Map, Parcel Ownership

MAP A

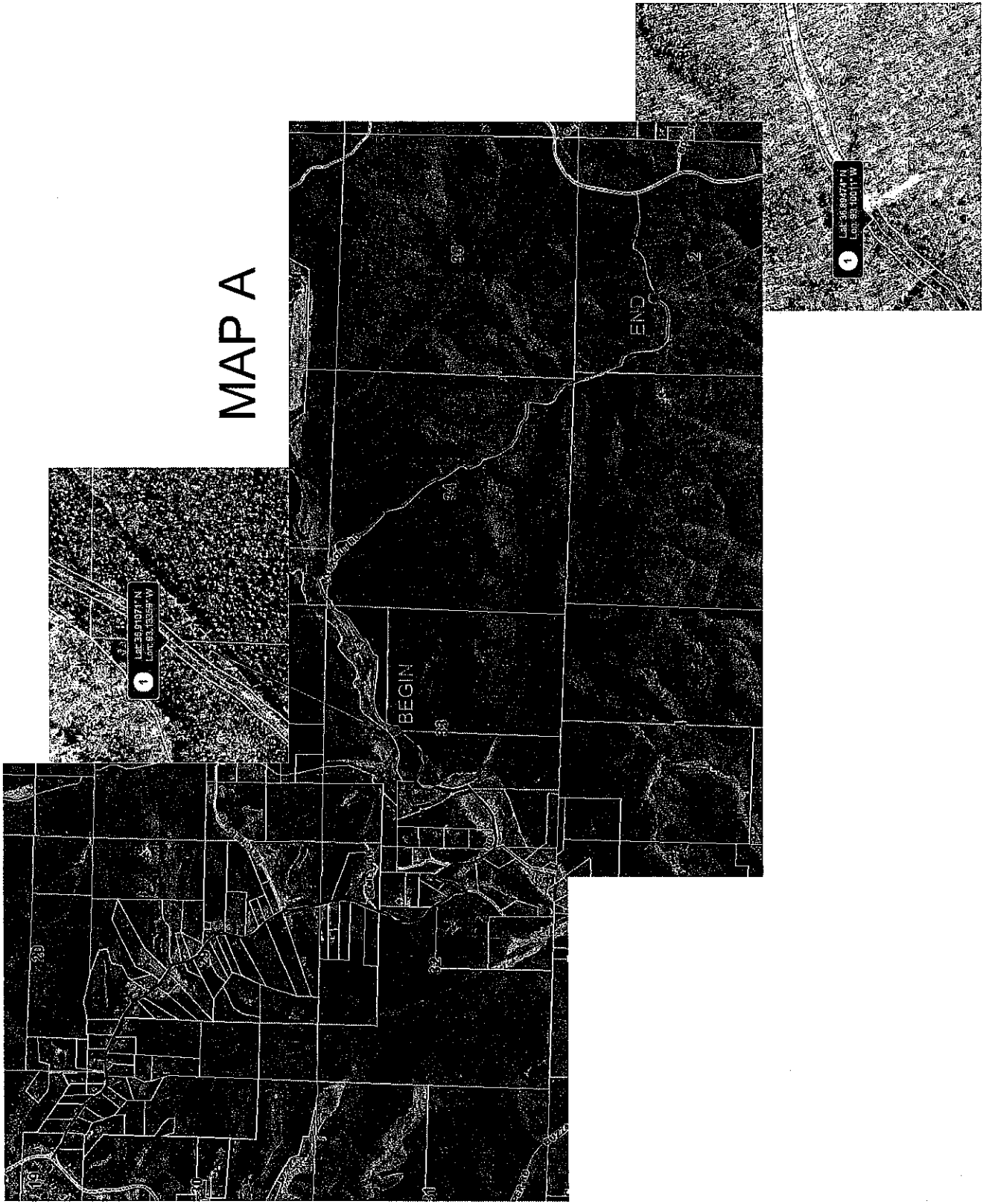

MAP B

 US GOV LAND

